

OUTDOOR SCOREBOARD



8436

Football
Baseball

Track (8436T or 8436H)

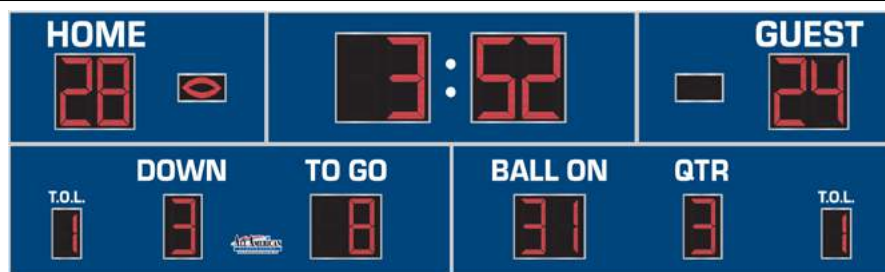
Soccer



OVERALL DIMENSION	10' high x 36' wide x 4.7" deep (including built-in mounting channel).
INFORMATION DISPLAYED	Home and Guest Score, Game Time, Time Outs Left, Down, To Go, Ball On, Quarter, Possession. <i>Information may vary depending on variations.</i>
DIGITS	36", 30", 24", 18" Bright Red, 7-Segment LEDs.
INDICATORS	8"x13" Bright Red LEDs, Football configuration.
CAPTIONS	White vinyl letters.
HORN	Horn not included. External 100 dB Vibrating Horn or 120dB Trumpet Horn are available.
CONSTRUCTION	Extruded aluminum frame, .093" thick, mill finish. Faces made from 22ga galvalume steel with shatter proof polycarbonate windows. Backs made from 22ga galvanized steel.
STANDARD COLORS (Custom Colors Available)	 <p>Black, Navy, Blue, Light Blue, and Red have a Kynar® finish, other standard and custom colors are powder coated or painted enamel.</p>
ELECTRONICS	100% solid state, microprocessor controlled system.
SERVICING	Front access for ease of servicing. Plug in modules for ease of replacement.
MICROPROCESSOR CONTROL CONSOLE	 <p>Sold separately. Extruded Aluminum, high impact low profile microprocessor control console, latest state of the art, user friendly. Size: 13.25" wide x 5" high x 9" deep. Weight: 6 lbs. Microprocessor to be supplied with 25 feet of cable (hardwire). Microprocessor control console with membrane keyboard provides for direct entry of all information. Radio Control is available.</p>
JUNCTION BOX	One outdoor rated junction box, 5" x 3" with cover and ethernet cable. (Hardwire)
DATA CABLE	Twisted pair, direct burial, RJ45 Connectors (Hardwire).
POWER REQUIREMENTS	115/230 VAC. 50/60 Hz. Minimum one 20A circuit is recommended.
INSTALLATION	All standard variations typically installed on four posts. Mounting kits are supplied with scoreboard. <i>NOTE: Number of posts must be determined locally by licenced engineer.</i>
WEIGHT	Net 1072 lbs / Estimated Shipping 2023 lbs.
WARRANTY	Five year guarantee against defects in materials and workmanship. Factory repair service for parts in warranty. Union label. UL Certified.
STANDARD VARIATIONS - Add suffix to model number in order that they appear below (see examples on next page)	
Model + T	5-Digit Timer (Tenths).
Model + H	6-Digit Timer (Hundredths).
Model + EC	12" LED Team Names (16x80 Matrix). Programmable from console.
Model + TN	12" LED Captions (16x96 Matrix). Programmable from console.
Model + RV2	Radio upgrade. 2.4 GHz spread spectrum, 1500' expected range.
SPORT CONVERSION KITS - Optional changeable placards to display correct captions for different sports (lower section)	
Baseball Conversion	Ball, Strike, Inning, Out - Inning is displayed in 3rd position to allow for extra innings
Track Conversion (T Models)	Lane, Place, Event, Heat
Soccer Conversion	C. Kicks (up to 9), SOG, SOG, C Kicks (up to 9)

EXAMPLES OF VARIATIONS

This page shows samples of boards within the 8436 family. Not all standards are shown. Boards that fall outside of these options will be considered custom and will require additional engineering.

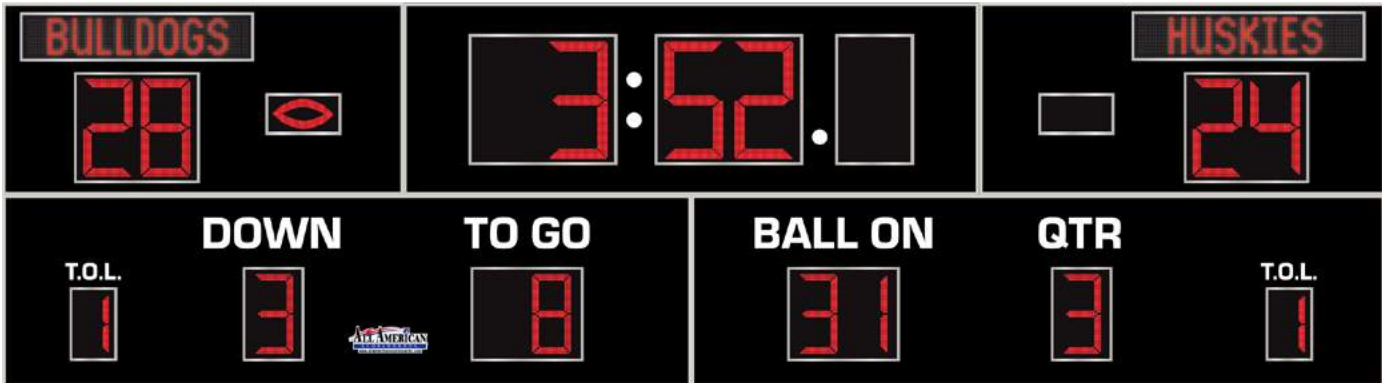

8436TTN - Tenths and Hundreths only displayed in track mode.

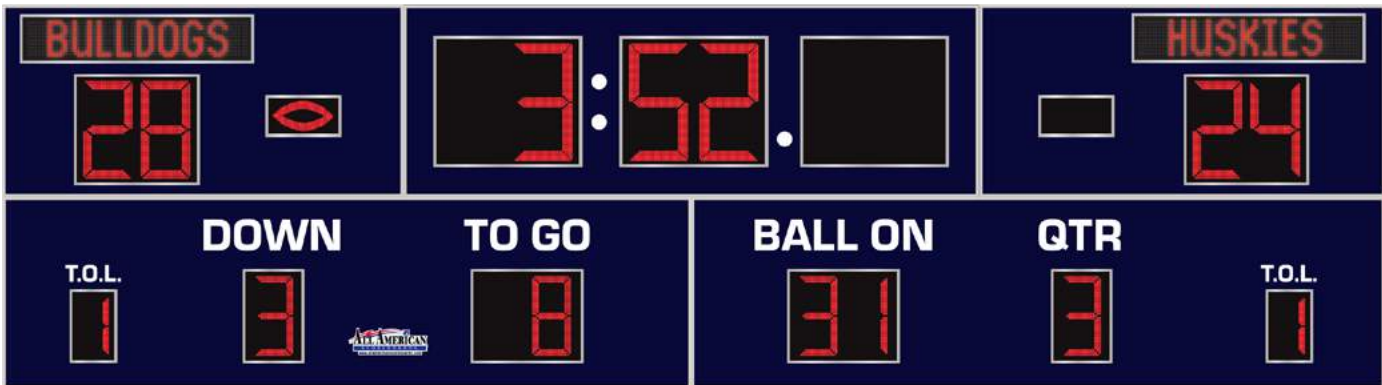

8436HTN - Tenths and Hundreths only displayed in track mode.

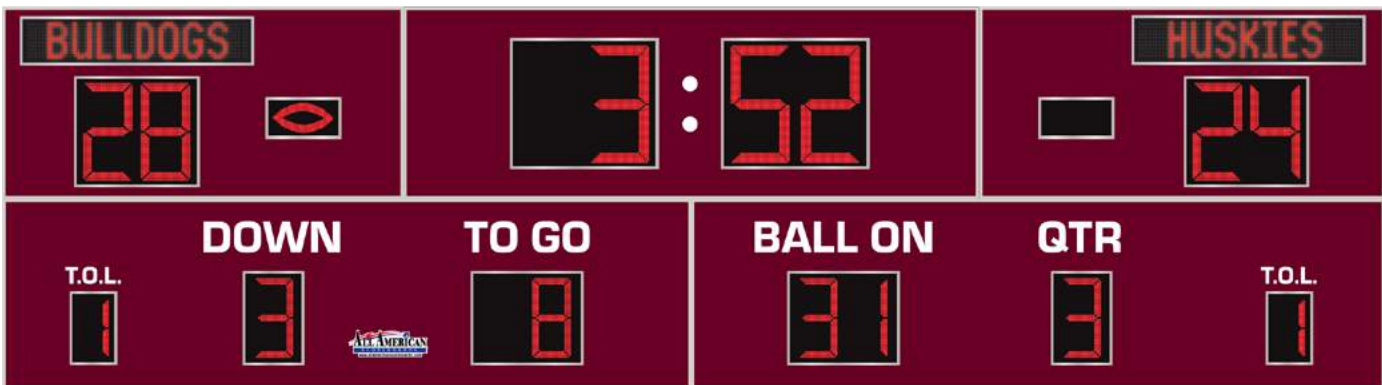

8436TN - LED Team Names in place of Vinyl Team Names.

Typical Multi-Cabinet Scoreboard Installation Illustration

NUMBER OF POLES SHOWN ONLY FOR REFERENCE. MUST BE DETERMINED LOCALLY BY LICENCED ENGINEER.

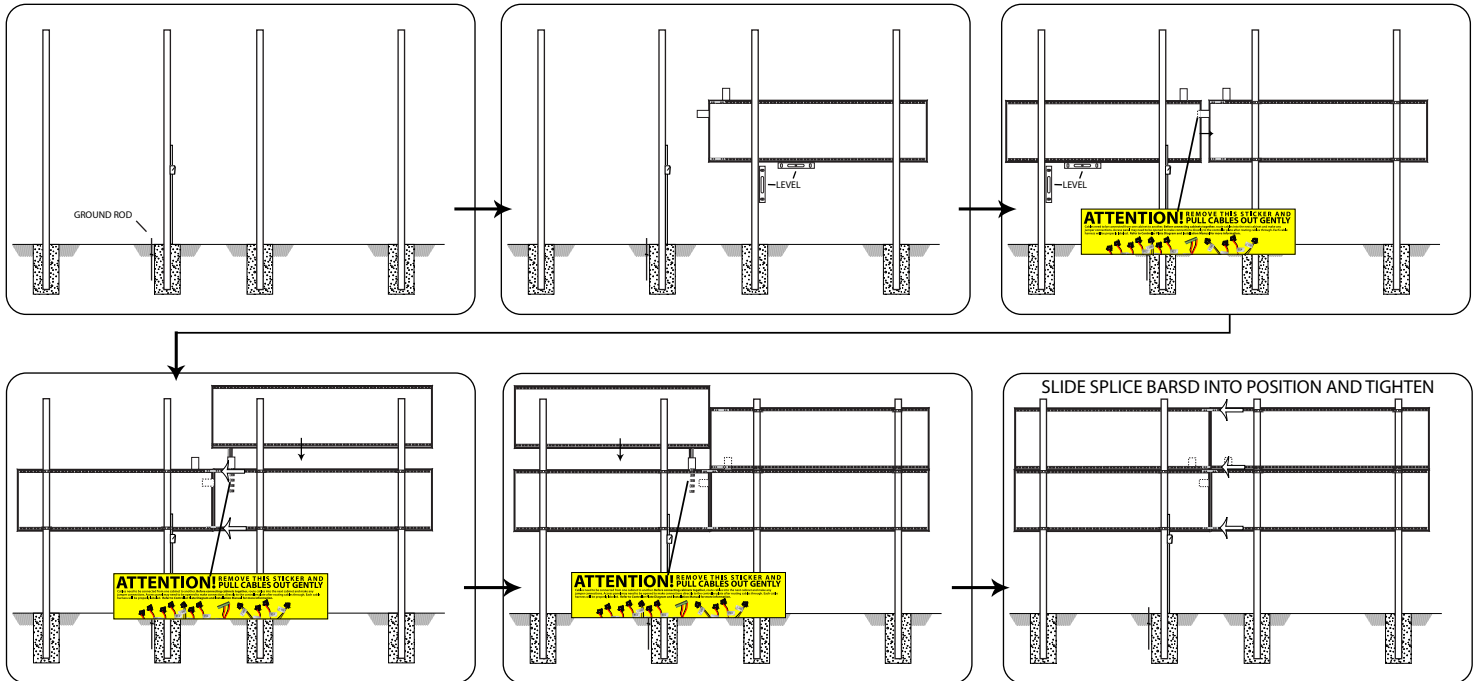

ATTENTION! REMOVE THIS STICKER AND PULL CABLES OUT GENTLY

Cables need to be connected from one cabinet to another. Before connecting cabinets together, route cables into the next cabinet and make any jumper connections. Access panel may need to be opened to make connections directly to the controller plate after routing cables through. Each cable harness will be properly labeled. Refer to Controller Plate Diagram and Installation Manual for more information.

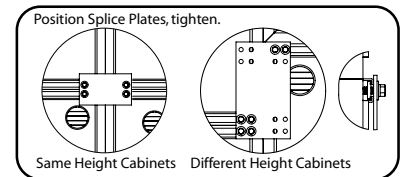
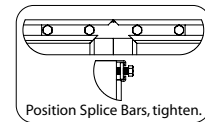

NOTE: EACH SCOREBOARD REQUIRES DIFFERENT HARDWARE AND CONFIGURATIONS. REFER TO ENGINEERING DRAWING.

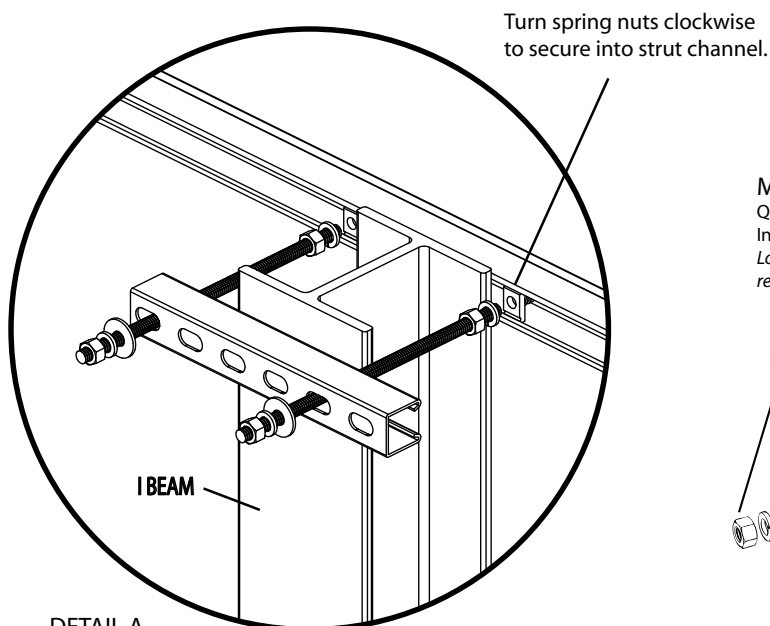

DETAIL A.
Pressure hold scoreboard cabinets to poles.
Secure with weld.

Mounting Kit

Quantity of kits depends on board and number of poles required. Installed at every point where a pole and a strut channel intersect. Local ordinances, soil conditions and wind load requirements may require additional structure.

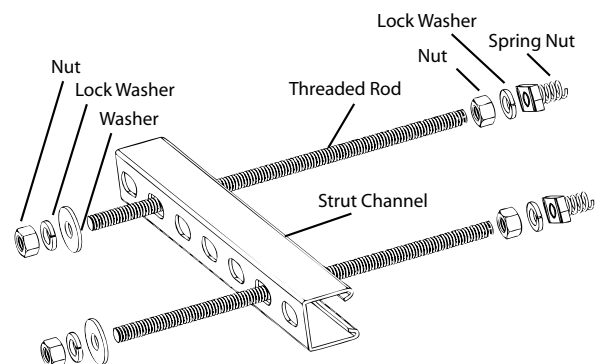

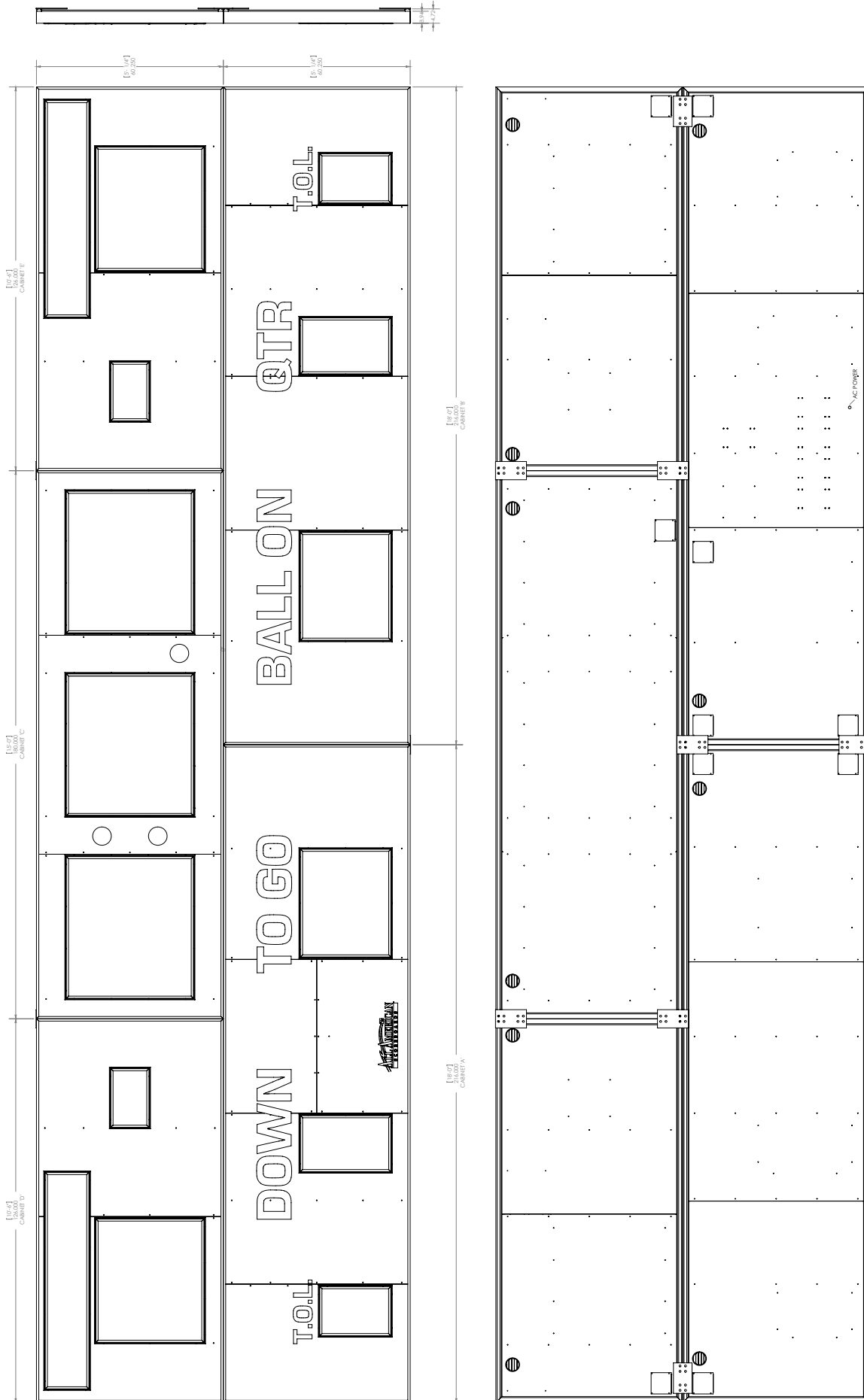

Hardwire Scoreboard Wiring

With a Standard Junction Box

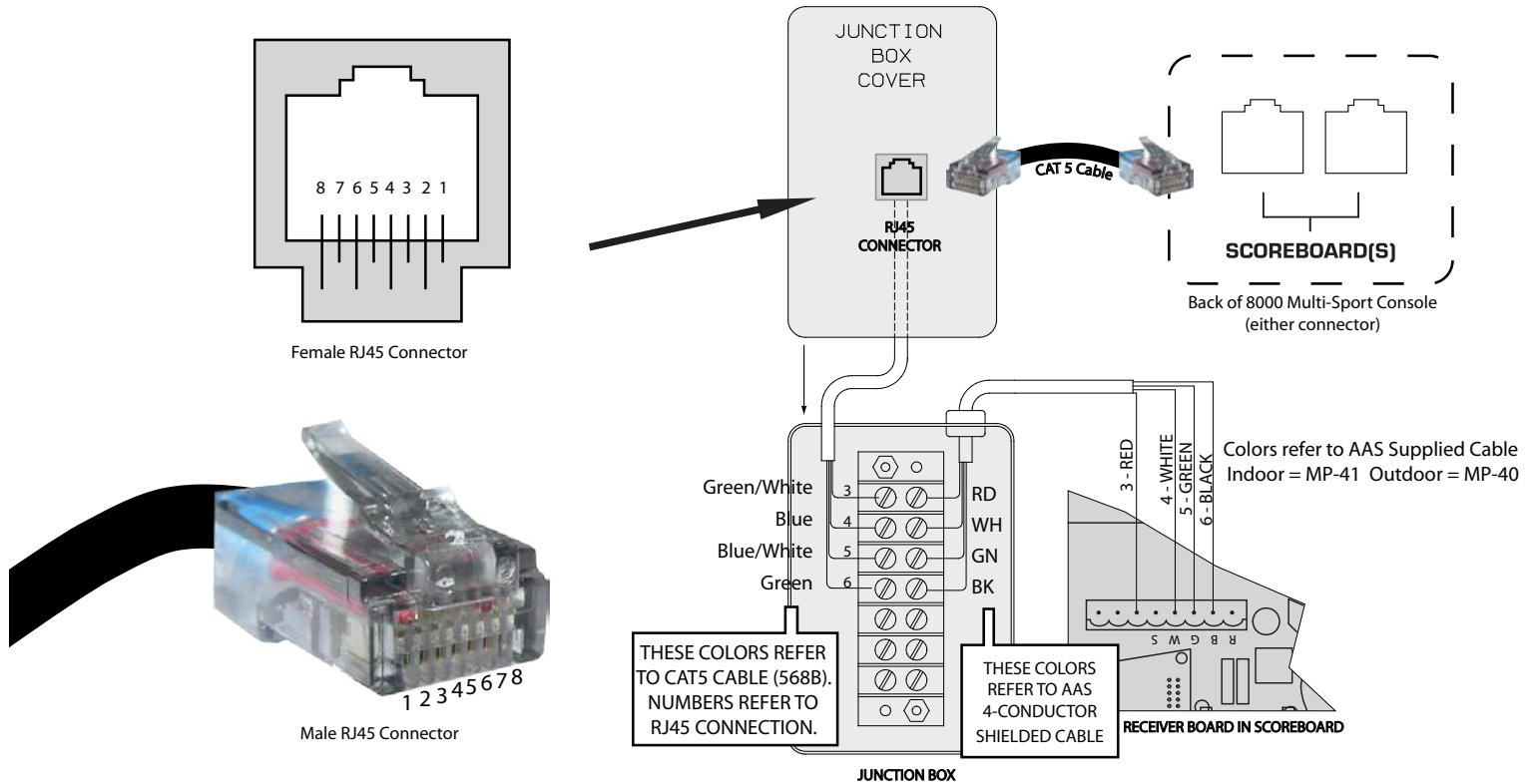

Wiring a Supplemental Display

With a Single Junction Box

